

WIND

Hardware & Engineering

Stock & Custom Hardware Components for OEMs Worldwide

Access Door Hardware

Cam Locks

Cash Box Locks

Casters

Catches

Dispenser Locks

Drawer Slides

Electrical Switch Locks

Furniture Locks

Handles

Knobs

Hinges

Identification Hardware

Latches

Leg Levelers

Luggage & Case Hardware

Miscellaneous Hardware

Padlocks

Postal Locks

Quarter Turns

Rivets & Specialty Screws

Toolbox Hardware

Truck Hardware



1 About Wind Hardware



When it comes to industrial hardware supplies and resources, Wind Hardware & Engineering is a leader in North America. We design, manufacture and manage an end-to-end supply chain for a wide variety of industrial hardware products including cam locks, furniture locks, drawer slides, handles, hinges, casters and fasteners. If you need a hardware component for your finished product, rest assured that Wind Hardware & Engineering is a trusted supplier you can count on.

Wind Hardware & Engineering has been a leader in quality and customer satisfaction since 1949, serving large and small manufacturers of office, industrial and laboratory furniture, dispensers, electronic enclosures, security products, woodworking, displays, luggage and cases as well as U.S. Government contracts.

For more information, email the Wind Hardware & Engineering team at sales@windcorp.com.



We deliver outstanding value through our Engineering, Quality, Supply, Custom Solutions and Service capabilities.

ENGINEERING

Wind Hardware & Engineering employs a full-time staff of engineers who will work efficiently and cohesively with your engineers and manufacturing team to produce technical drawings, CAD/CAM designs, including 3D Modeling to prototypes and pre-production samples. By working directly with you and your team, Wind Hardware & Engineering saves you time, money and helps to prevent delays in manufacturing, excess inventories and costly oversights that can occur in the design and prototyping processes.

QUALITY SYSTEMS

We achieved ISO 9001:2000 certification in 2004 and constantly strive to maintain exceptional standards and preserving quality processes. We've implemented quality control procedures in every aspect of our business to ensure that we consistently deliver on our promise of quality. In conjunction with these standards, we execute ISO compliant systems: where product quality is monitored and tested at all stages of production including pre-production, in process, post-production and at the point of shipping. Wind Hardware & Engineering also warrants its products against defects in materials and workmanship.

SUPPLY CHAIN

If you're an original equipment manufacturer (OEM), you'll be happy to know that Wind Hardware & Engineering provides complete hardware component sourcing solutions. Core to our value proposition is taking the difficulty out of sourcing small, but mission critical components required for your manufacturing operation. Wind Hardware & Engineering's supply chain and services streamline the procurement and fulfillment processes, reducing costs and improving profitability while driving reductions in inventory levels. The end result is a better return for your business.

CUSTOM SOLUTIONS

We realize that, in today's business climate of short project timelines, customization and pressure on price and lead time, sometimes a standard component or supply chain model just won't do. That's why, in addition to a wide variety of standard and stocked components, we specialize in developing custom components and supply chain solutions that help you simplify your business, reduce total cost and get to market faster. Wind Hardware is ISO 9001:2000 compliant with products that are NSF certified and conforming to European RoHS and Semi S8 directives. If you can't find the right hardware component in our catalog, our team can make it for you and develop a supply chain model that meets your specific needs. Within a few months, you'll have the parts you need to get on with business.

SERVICE

The average tenure of our sales and customer service team is over 10 years and we realize that, ultimately, service is what wins and keeps customers. Everyone in our organization, from our sales team to our warehouse team, is focused on one thing: satisfying our customers. Our product knowledge, design capabilities, customer service and responsiveness are second to none and the primary reason we enjoy long lasting relationships with so many satisfied customers across so many industries.

CONTACT US

Email: sales@windcorp.com
Phone: 800-946-3267
Fax: 203-778-1006
Web: www.windhardware.com
30 Pecks Lane
Newtown, CT 06470 USA

CATALOG DISCLAIMER

Every effort has been made to ensure that all dimensions and diagrams are correct. It should be noted that dimensions of products, design of products, and availability of products is subject to change. For detailed information on any of the products in this catalog, contact your Wind Hardware & Engineering sales representative.

Wind Hardware & Engineering warrants its products against defects in material and workmanship to the original purchasers of product as originally installed and purchased. This warranty does not cover product which has been damaged due to abuse, modifications of product, improper installation, excessive loads, or product used in applications not approved by the company. We will send the original purchaser a replacement, similar or like model, at no cost. This warranty covers replacement of original product only and does not cover costs to remove, re-installation, or other incidental changes. To obtain a replacement product covered by this warranty, simply contact us at 1-800-946-3267.

“ We have been a customer of Wind Corp. for over 20 years. As a manufacturer we are always striving to find material quickly and at the lowest price. Wind has been a great partner in achieving this goal. Many companies are looking overseas for material but often have to procure larger quantities than necessary and the lead times are extremely long. Companies like Wind Corp have helped us avoid having to make such an investment. Both their stock levels and prices are a perfect fit for our business and I would highly recommend them to everyone. ”

John, Display Industry, Rhode Island

3 Table of Contents



Access Door Hardware	21	Handles	18
Cam Locks	4	In Stock	18
In Stock	4	Custom	19
Levers	6	Locking &	
Custom	7	Non-Locking	20
Plastic	8	Knobs	19
Options	9	Hinges	22
Cash Box Locks	27	Identification Hardware	27
Casters	25	Latches	24
Furniture	25	Leg Levelers	25
Specialty	25	Luggage & Case Hardware	29
Light Duty	26	Miscellaneous Hardware	30
Medium Duty	26	Padlocks	10
Heavy Duty	26	Postal Locks	12
Extra Heavy Duty	26	Quarter Turns	13
Catches	24	Rivets & Specialty Screws	27
Dispenser Locks	27	Toolbox Hardware	28
Drawer Slides	14	Truck Hardware	28
In Stock	14		
Custom	15		
Heavy Duty	17		
Electrical Switch Locks	12		
Furniture Locks	11		

10313 - 7/16" CHROME PLATED CAM LOCK

- Zinc alloy die cast housing & cylinder
- Chrome plated
- Hex nut mounted
- Hex nut cam lever mounting
- 90° clockwise rotation
- Key removable in both positions
- WS93 key combination
- Two keys on a ring

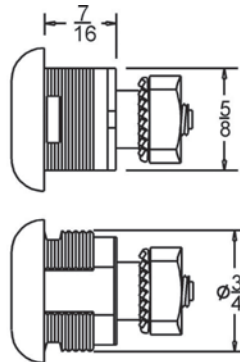

10293 - 5/8" CHROME OR BRASS PLATED CAM LOCK

- Zinc alloy die cast housing & cylinder
- Chrome or brass plated
- Hex nut mounted
- Screw-on cam lever mounting
- 90° clockwise rotation
- Key removable in both positions
- WS93 key combination
- Two keys on a ring

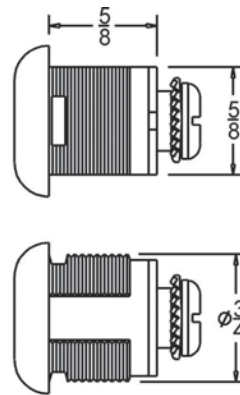

10168 - 5/8" STAINLESS STEEL FACE CAM LOCK

- Zinc alloy die cast housing & cylinder
- Hex nut mounted
- Screw-on cam lever mounting
- 90° clockwise rotation
- Stainless steel scalp & plug face
- Key removable in both positions
- PK625 key combination
- Two keys on a ring

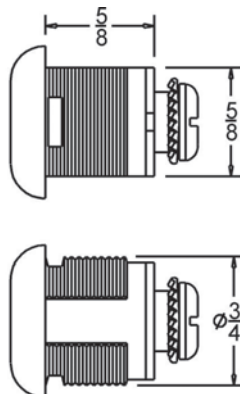

5 Cam Locks In Stock



10265 - 5/8" CHROME OR BRASS PLATED MINI CAM LOCK

- Zinc alloy die cast housing & cylinder
- Hex nut mounted
- 90° clockwise rotation
- Key removable in both positions
- Chrome or brass plated
- Supplied with assembled 1" straight cam
- W-23 key combination
- Two keys on a ring

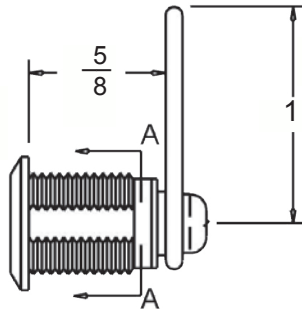
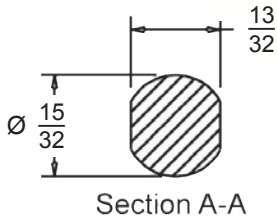

10296 - 7/8" CHROME PLATED CAM LOCK

- Zinc alloy die cast housing & cylinder
- Chrome plated
- Hex nut mounted
- Screw-on cam lever mounting
- 90° clockwise rotation
- Key removable in both positions
- WS93 key combination
- Two keys on a ring

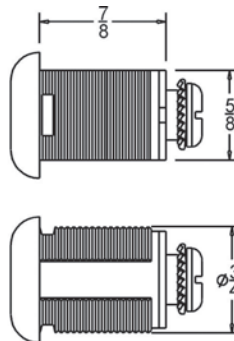

10363 - 1-3/16" NICKEL PLATED CAM LOCK

- Zinc alloy die cast housing & cylinder
- Nickel plated
- Hex nut mounted
- Screw-on cam lever mounting
- 90° clockwise rotation
- Key removable in both positions
- C415A or WS93 (10857) key combinations available
- Two keys on a ring

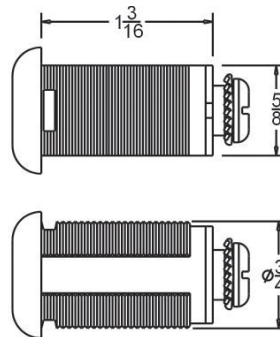

“ Wind Hardware & Engineering become a trusted partner for our business. Their quality and on time delivery is a given and we are happy to maintain and grow our business together. ”
 Jorge, Commercial Irrigation, California

10612 - 17mm (43/64") CHROME PLATED TUBULAR KEY CAM LOCK

- High security 7 pin tumbler
- Zinc Alloy die cast housing & cylinder
- Hex nut mounted
- Hex nut cam lever mounting
- 90° clockwise rotation
- Chrome Plated
- Double pull, key removable in both positions
- Supplied with 1-1/4" long offset cam lever
- #2101 key combination
- Supplied with one key

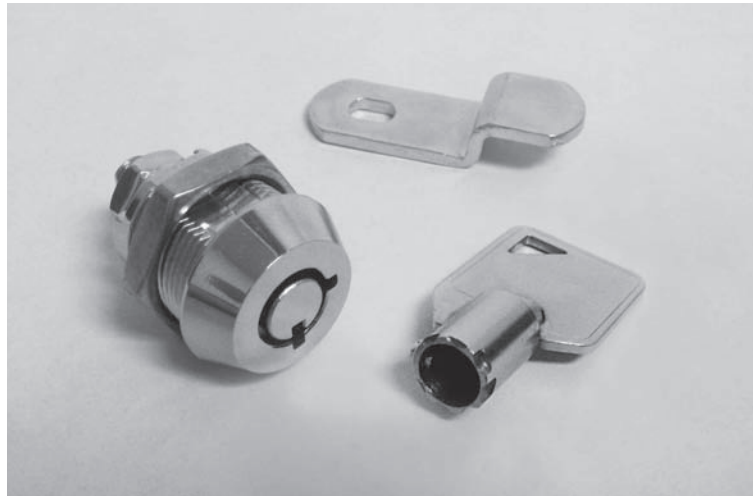

STOCK CAM LOCK LEVERS

These cam levers are in stock and available for immediate shipment. In addition, Wind Hardware & Engineering can manufacture custom orders for you in any size, shape, finish, or material. Please contact us with your exact requirements.

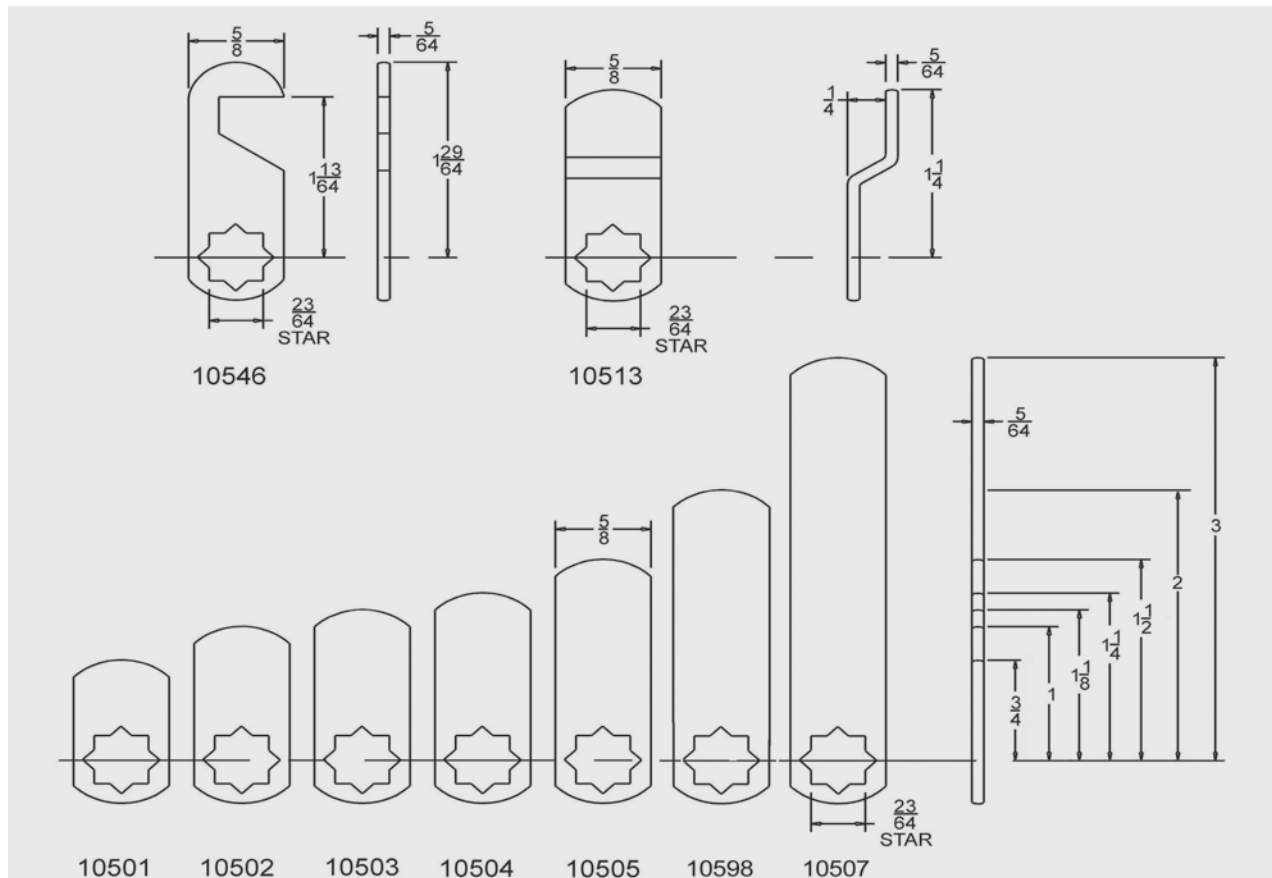



CUSTOM DESIGNS TO YOUR SPECIFICATIONS AVAILABLE

10259 & 10855 - SNAP-IN CAM LOCKS

- For quick mount / snap-in applications
- Zinc alloy die cast housing & cylinder
- Screw-on cam lever mounting
- 90° or 180° degree rotation
- Key removable in both positions
- Multiple key changes available
- For material thicknesses of 1/32" to 1/16"
- Various finishes available



10742 - FILE CABINET LOCK

- Zinc alloy die cast housing & cylinder
- Fork clip mounted
- Multiple key changes available
- Master keyed
- Core removable feature
- Nickel plated



12009 - TUBULAR PUSH KEY LOCK

- High security applications
- Zinc alloy die cast housing & cylinder
- Hex nut mounted
- Chrome plated
- Single pull, key removable in locked position
- Multiple key changes available



10436 - SPECIAL LEVER CAM LOCK

- Double cam lever application
- Zinc alloy die cast housing & cylinder
- Fork clip or hex nut mounted
- Screw-on cam lever mounting
- 90° rotation
- Various barrel lengths available
- Various finishes available



CUSTOM DESIGNS TO YOUR SPECIFICATIONS AVAILABLE**DOUBLE BITTED CAM LOCKS**

- Higher security 11 disc wafer mechanism
- Zinc alloy die cast housing & cylinder
- Hex nut mounted or fork clip
- Hex nut or spun-on cam lever mounting
- Various barrel lengths available
- Various finishes available

**10727 - SPRING BOLT LOCK**

- Slam action, spring returned bolt
- Zinc alloy construction
- Master keying available
- Up to 100 key changes available
- Various finishes available

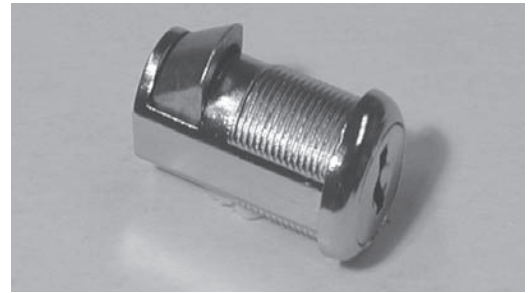
**Plastic Cam Locks****10741 - PLASTIC SNAP-IN CAM LOCK**

- ABS material
- Snap-in mounting
- Push-on cam lever mounting
- Colors available (easy color matching)
- Nickel & other plating available
- Barrel length: 19/32"
- For material thicknesses of 0.125" to 0.15"

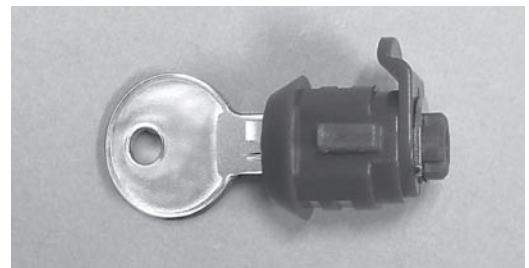
**10699 - PLASTIC CAM LOCK**

- ABS material
- Hex nut or fork clip mounted
- Screw-on cam lever mounting
- 90° or 180° rotation
- Barrel lengths: 3/8", 5/8", 27/32", 1-3/32"
- Chrome, nickel or brass plate available
- Various colors available



9 Cam Lock Options



CAM LOCK MOUNTING OPTIONS



Fork Clip



Hex Nut



Snap-In



Plastic Snap-In



Rear Mounted

CAM LEVER MOUNTING OPTIONS



Screw



Spun-On



Push-On



Hex Nut

CAM LOCK ACCESSORIES



92014



92013



10059



Dust Shutter



92027

RECOMMENDED CAM LOCK CUTOUTS

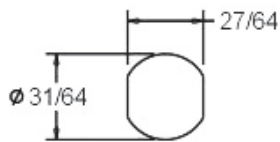

Mini

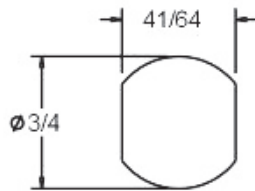

Standard

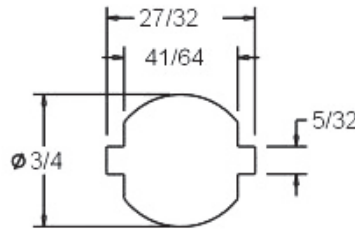

Plastic

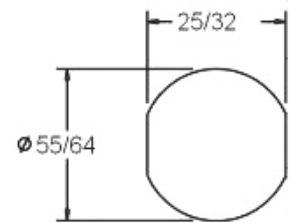

Large

VARIOUS CAM LEVER STYLES



Straight

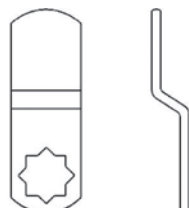

Offset (In)

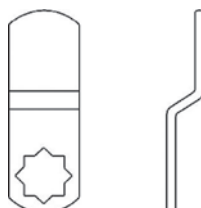

Offset (Out)

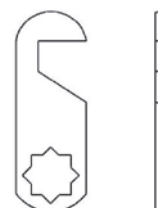

Hook

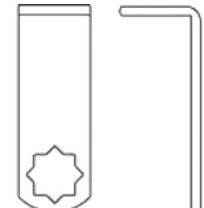

Bent

LUGGAGE & DISPLAY PADLOCKS

18017

- Zinc alloy with nickel or brass finish
- Two keys per lock
- **IN STOCK**

18071

- Solid brass with brushed finish
- Two keys per lock
- **IN STOCK**

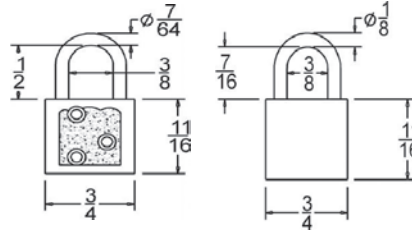

18051 - LAMINATED STEEL PADLOCK

- Meets ASTM-F883 specifications
- 200 key changes available
- Two nickel plated brass keys on a ring
- Hardened steel shackle
- Zinc plated

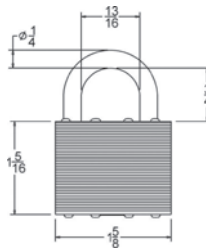

1925 - KEY CONTROLLED ANTI-SHIM COMBINATION PADLOCK

- New anti-shim feature resists the most common shimming methods
- New case hardened steel post added to shackle for added protection to lock mechanism
- Stainless steel body for greater security & durability
- Supervisory key control
- Hardened steel, chrome plated shackle
- Requires a padlock eye of at least 5/16"
- Also available without supervisory key control feature

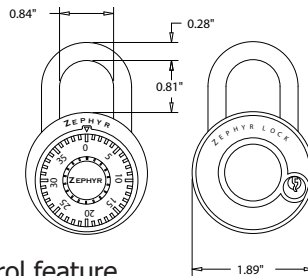

18050 - LAMINATED STEEL COMBINATION PADLOCK

- Meets ASTM-F883 specifications
- 10,000 resettable combinations
- Resets with change tool
- Hardened steel shackle
- Latch mechanism is a double dead bolt

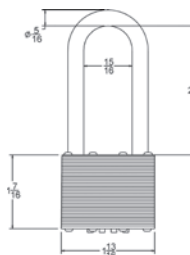

18048 - SOLID BRASS PADLOCK

- Solid brass case
- Mushroom pins for security
- Hardened steel shackle
- Short & long shackle available
- Available in 20mm to 70mm sizes

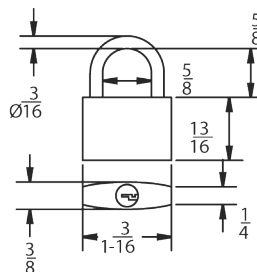

11 Furniture Locks



19034 - PUSH LOCK

- Rear mounted "push lock" ideal for applications which include sliding doors & credenzas
- Key unlocks & automatically withdraws dead bolt mechanism
- Easy one finger push to close & lock
- Can be master keyed
- Face ring available for finished appearance
- Various finishes available

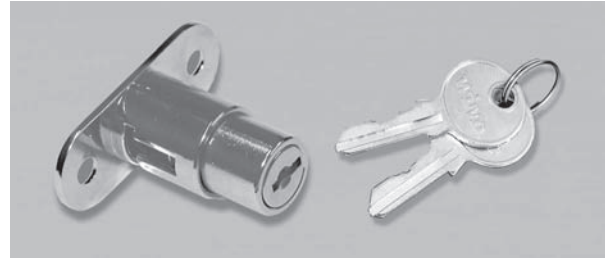

10624 - REAR MOUNTED FURNITURE LOCK

- Rear mounted furniture lock application
- Zinc alloy die cast housing & cylinder
- Core removable & master key features available
- Dual entry key with plastic cap
- Face ring available for finished appearance
- Various finishes available



11020 - DESK DRAWER LOCK

- For desk drawers & cabinets
- Zinc alloy die cast housing & cylinder
- Various bolt configurations available
- Rear mounted
- Core removable & master key features available
- Dual entry key with plastic cap
- Face ring available for finished appearance
- Various finishes available



11022 - MULTI-DRAWER SYSTEM LOCK

- For multi-drawer systems
- Zinc alloy die cast housing & cylinder
- Includes control bar & fasteners
- Rear mounted
- Core removable & master key features available
- Dual entry key with plastic cap
- Face ring available for finished appearance
- Various finishes available

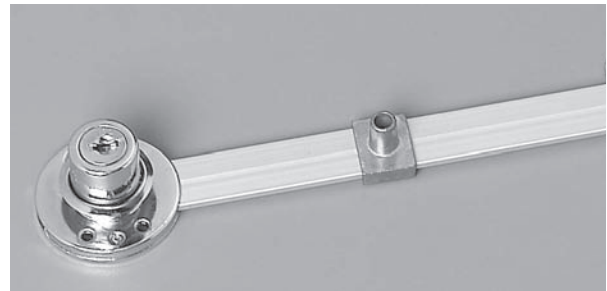

15048 - SLIDING GLASS DOOR LOCK

- Designed for locking sliding doors
- Zinc alloy die cast construction with steel locking bar
- Adjustable for various door thicknesses
- Special keying available
- Supplied with two keys per lock
- Various finishes available



10704 - POSTAL LOCK

- Pin tumbler / high security mechanism
- 1000 key changes available
- Zinc alloy die cast housing & cylinder
- Nickel plated
- Supplied with two keys & mounting clip



10617 - REAR MOUNTED POSTAL LOCK

- Rear mounted postal application
- Zinc alloy die cast housing & cylinder
- Screw mounted
- Zinc plated
- Supplied with two keys
- **IN STOCK**



10277 - REAR MOUNTED BRASS POSTAL LOCK

- Rear mounted Postal application
- Solid brass die casting for housing & cylinder
- Screw-on cam lever housing
- Screw mounted
- Key removable in the 12:00 position
- Supplied with three keys
- **IN STOCK**



Electrical Switch Locks

ELECTRICAL SWITCH LOCKS

- Available in various electrical ratings (both voltage & amps)
- Zinc alloy die cast housing & cylinder
- Hex nut mounted
- Tubular, double bitted, or single bitted keys available
- Various barrel lengths available
- Chrome, nickel, & black finishes

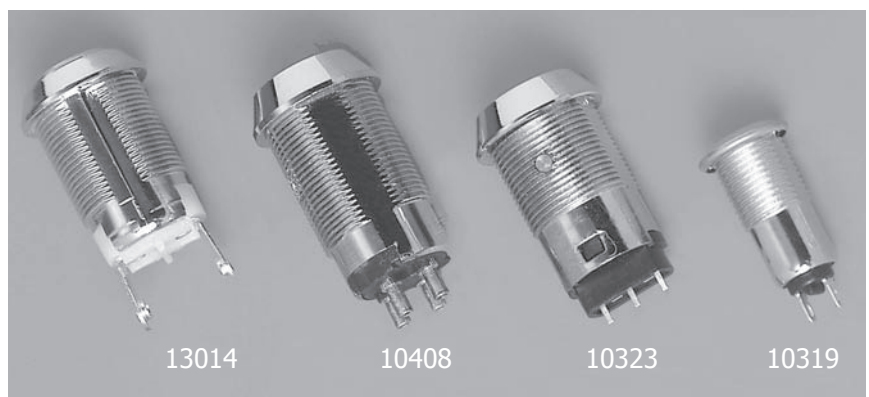

13 Quarter Turns



THUMB TURNS

- Zinc alloy die cast housing & cylinder
- Barrel lengths: 5/8", 7/8", 1-1/8"
- Hex nut mounted
- Chrome finish available from stock
- Supplied with a prong washer, collar and two levers
- **IN STOCK**

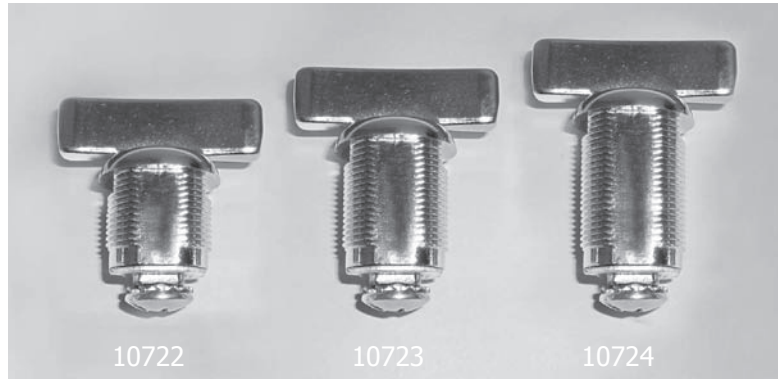

QUARTER TURN LATCHES

- Zinc alloy die cast housing & cylinder
- Barrel length: 5/8"
- Hex nut mounted
- Various finishes available



HEAVY DUTY QUARTER TURN LATCHES

- Zinc alloy die cast housing & cylinder
- Barrel length: 11/16"
- Hex nut mounted
- Operating tools available
- Various finishes available

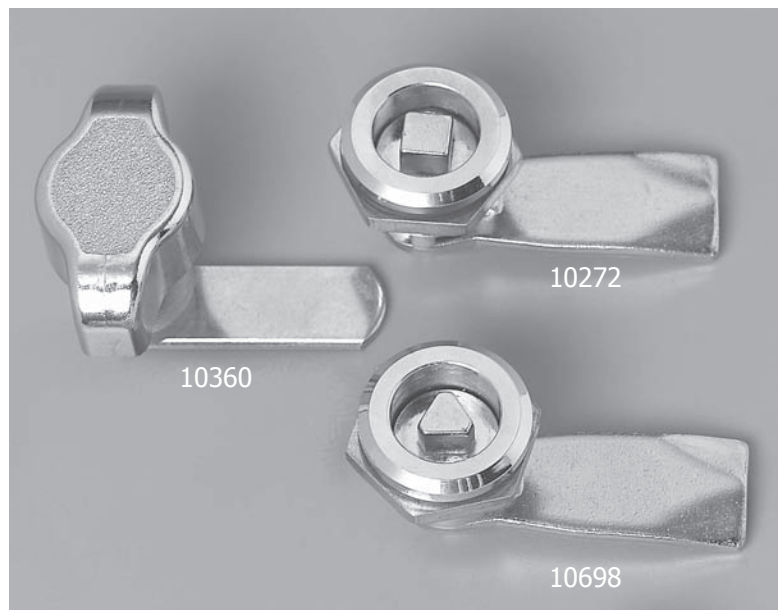

“ Our company has partnered with Wind Corporation for over 15 years, and we have been pleased with the partnership from the beginning. Wind has always gone the extra mile to keep the supply lines working.

Jeff B., Fire, Safety, and Security, Minnesota ”

45MM 100 LB. FULL EXTENSION

- Applications: Office furniture, casework, kitchen & home cabinets, electronic enclosures and tool boxes
- Features: 1.25" (32mm) hole system, separable inner channel, fine adjustment for gap, hardened steel ball bearings
- Slide Travel: 1/2" over travel (1/2" over extension)
- Material: Work hardened cold rolled steel
- Finish: Electro-zinc plated with clear chromate; black electrocoat available
- Slide Lengths: Even lengths 10" to 24"; custom sizes available
- Load Rating: 100 lbs. per pair (18" standard)
- Packaging: 15 pair per box - unassembled packaging available on custom orders
- Meets ANSI/BIFMA / KCMA standards

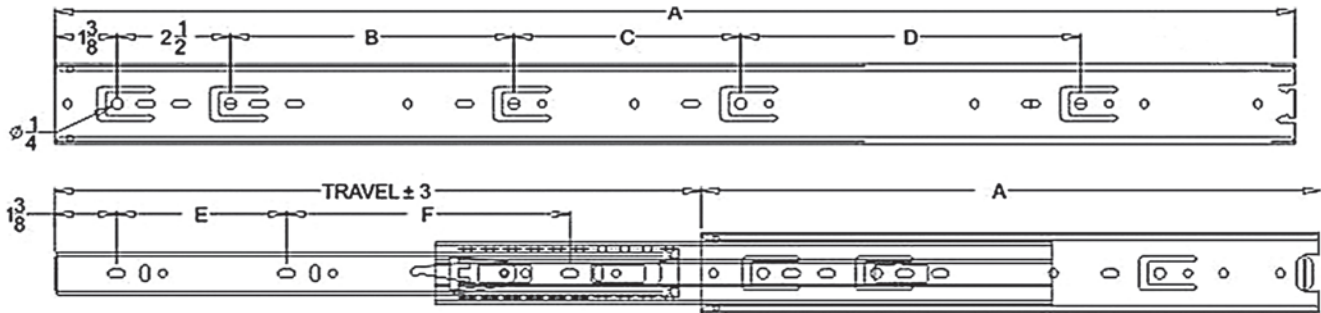
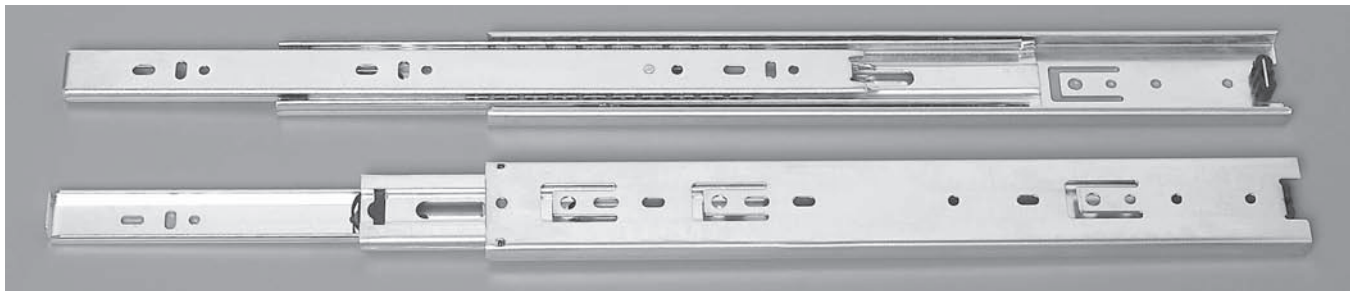

Wind Part Number	Size (inches)	A	B	C	D	E	F	Travel
71002	10	9 ²⁷ / ₃₂	3 ²⁵ / ₃₂			2 ¹⁷ / ₃₂	5 ¹ / ₃₂	10 ⁷ / ₁₆
71004	12	11 ¹³ / ₁₆	6 ⁵ / ₁₆			3 ²⁵ / ₃₂	5 ¹ / ₃₂	12 ¹³ / ₃₂
71006	14	13 ²⁵ / ₃₂	6 ⁵ / ₁₆			3 ²⁵ / ₃₂	6 ⁵ / ₁₆	14 ³ / ₈
71008	16	15 ³ / ₄	6 ⁵ / ₁₆	2 ¹⁷ / ₃₂		5 ¹ / ₃₂	7 ⁹ / ₁₆	16 ¹¹ / ₃₂
71010	18	17 ²³ / ₃₂	6 ⁵ / ₁₆	5 ¹ / ₃₂		6 ⁵ / ₁₆	7 ⁹ / ₁₆	18 ⁵ / ₁₆
71012	20	19 ¹¹ / ₁₆	6 ⁵ / ₁₆	5 ¹ / ₃₂	2 ¹⁷ / ₃₂	7 ⁹ / ₁₆	8 ¹³ / ₁₆	20 ⁹ / ₃₂
71014	22	21 ²¹ / ₃₂	6 ⁵ / ₁₆	5 ¹ / ₃₂	2 ¹⁷ / ₃₂	7 ⁹ / ₁₆	10 ³ / ₃₂	22 ¹ / ₄
71016	24	23 ⁵ / ₈	6 ⁵ / ₁₆	5 ¹ / ₃₂	5 ¹ / ₃₂	8 ¹³ / ₁₆	11 ¹¹ / ₃₂	24 ⁷ / ₃₂

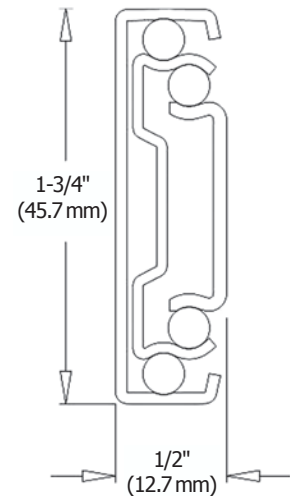

Disclaimer: Our drawer slides meet industry-accepted guidelines using a minimum testing of 50,000 cycles that follow the ANSI/BIFMA specifications. Each slide is rated for a dynamic load that will not fail using an 18" pair. The load rating of each drawer slide will decrease proportionally beyond the 18" length. The static load capacity of each model is at least twice the dynamic load rating even when the slide is loaded to its maximum rating. Each slide should be tested in the intended application by the customer to make sure performance is not affected.



CUSTOM DESIGNS TO YOUR SPECIFICATIONS AVAILABLE

45MM 100 LB. BAYONET MOUNTING FULL EXTENSION

- Applications: Metal office & industrial furniture; metal cabinets, electronic enclosures and tool boxes
- Features: Simple insert type installation, separable inner channel, hardened steel ball bearings
- Slide Travel: 1/2" over travel
- Material: Work hardened cold rolled steel
- Finish: Electro-zinc plated with clear chromate; black electrocoat available
- Slide Lengths: Even lengths 10" to 24"; custom sizes available
- Load Rating: 100 lbs. per pair (18" standard)
- Packaging: 15 pair per box - unassembled packaging available on custom orders
- Meets ANSI/BIFMA / KCMA standards



45MM 100 LB. SELF-CLOSING FULL EXTENSION

- Applications: Medical carts, office furniture, electronic enclosures, storage cabinets, tool boxes
- Features: 1.25" (32mm) hole system; separable inner channel; fine adjustment for gap; hardened steel ball bearings
- Slide Travel: 1/2" over travel
- Material: Work hardened cold rolled steel
- Finish: Electro-zinc plated with clear chromate; black electrocoat available
- Slide Lengths: Even lengths 10" to 24"; custom sizes available
- Load Rating: 100 lbs. per pair (18" standard)
- Packaging: 15 pair per box - unassembled packaging available on custom orders
- Meets ANSI/BIFMA / KCMA standards

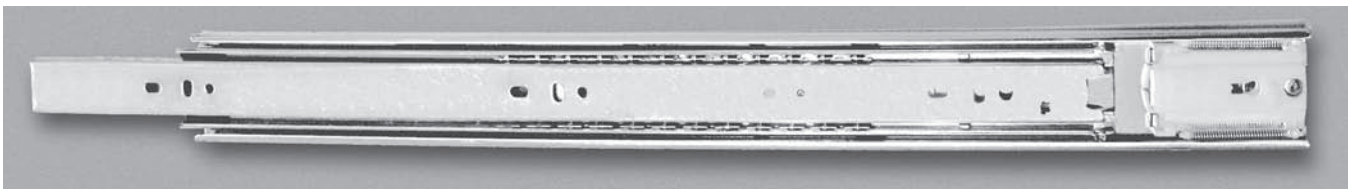

DRAWER SLIDE MOUNTING OPTIONS - CUSTOM HOLE & BAYONET CONFIGURATIONS AVAILABLE

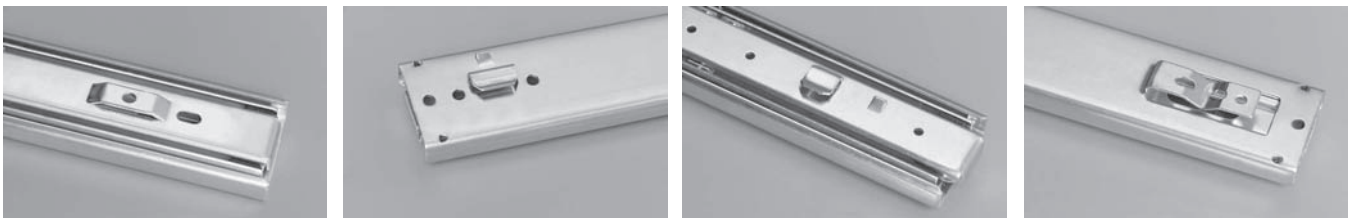

Disclaimer: Our drawer slides meet industry-accepted guidelines using a minimum testing of 50,000 cycles that follow the ANSI/BIFMA specifications. Each slide is rated for a dynamic load that will not fail using an 18" pair. The load rating of each drawer slide will decrease proportionally beyond the 18" length. The static load capacity of each model is at least twice the dynamic load rating even when the slide is loaded to its maximum rating. Each slide should be tested in the intended application by the customer to make sure performance is not affected.

CUSTOM DESIGNS TO YOUR SPECIFICATIONS AVAILABLE**35MM 75 LB. FULL EXTENSION & 50 LB. 3/4 EXTENSION**

- Applications: Office & home furniture, metal cabinets, kitchen cabinets, computer keyboard drawers
- Full Extension Features: Hole or bayonet mounting; separable inner channel; hardened steel ball bearings
- 3/4 Extension Features: (75% of slide length) - hole or bayonet mounting; inseparable channel; hardened steel ball bearings
- Slide Travel: Full extension or 3/4 extension (75% of slide length)
- Material: Work hardened cold rolled steel
- Finish: Electro-zinc plated with clear chromate; black electrocoat available
- Slide Lengths: Even lengths 10" to 24"; custom sizes available
- Load Rating: Full extension - 75 lbs. per pair; 3/4 extension - 50 lbs. per pair (18" standard)
- Meets ANSI/BIFMA / KCMA standards

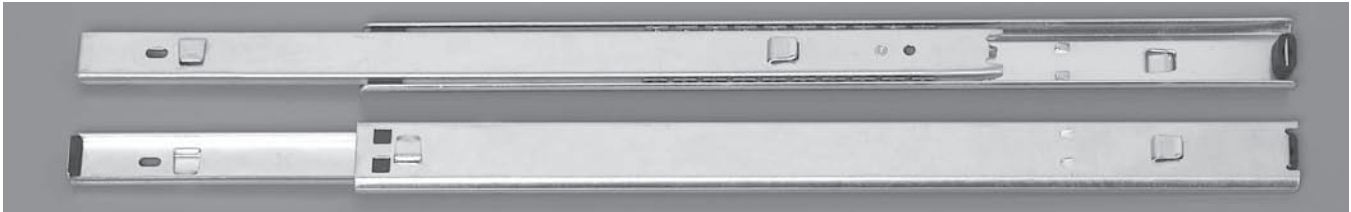
**35MM FLIPPER DOOR & OVERHEAD DOOR SLIDES**

- Applications: Overhead door for office systems, television chests, overhead storage systems
- Features: Thin profile, inseparable, brake stopping structure; may be installed horizontally; hardened steel ball bearings
- Material: Work hardened cold rolled steel
- Finish: Electro-zinc plated with clear chromate; black electrocoat available
- Slide Lengths: Even lengths 10" to 24"; custom sizes available
- Load Rating: 16 lbs. per pair (18" standard)
- Meets ANSI/BIFMA / KCMA standards

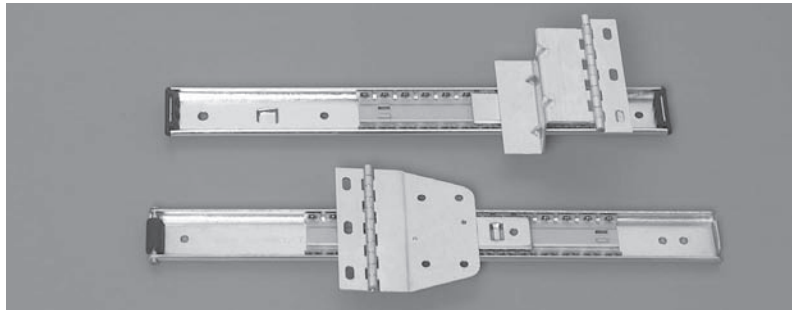
**35MM 1/2 OVER-TRAVEL POCKET DOOR**

- Applications: Retractable door for television, entertainment center, wall chest & overhead storage systems
- Features: Thin profile, inseparable, brake stopping structure; may be installed horizontally or vertically; hardened steel ball bearings
- Material: Work hardened cold rolled steel
- Finish: Electro-zinc plated with clear chromate; black electrocoat available
- Slide Lengths: Even lengths 10" to 24"; custom sizes available
- Load Rating: 20 lbs. per pair (18" standard)
- Meets ANSI/BIFMA / KCMA standards

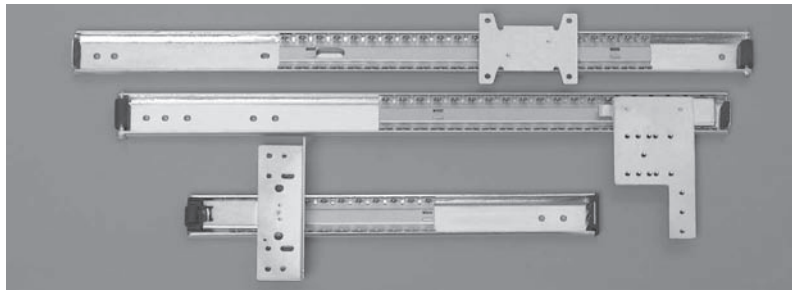

Disclaimer: Our drawer slides meet industry-accepted guidelines using a minimum testing of 50,000 cycles that follow the ANSI/BIFMA specifications. Each slide is rated for a dynamic load that will not fail using an 18" pair. The load rating of each drawer slide will decrease proportionally beyond the 18" length. The static load capacity of each model is at least twice the dynamic load rating even when the slide is loaded to its maximum rating. Each slide should be tested in the intended application by the customer to make sure performance is not affected.

17 Heavy Duty Drawer Slides



53MM ANTI-TILT INTERLOCKING SYSTEM

- Applications: Lateral files, file drawers, storage drawers
- Features: Prevents multi-drawer openings; rear locking interlock mechanism; hardened steel ball bearings
- Slide Travel: Full extension
- Material: Work hardened cold rolled steel
- Finish: Electro-zinc plated with clear chromate; black electrocoat available
- Slide Lengths:
 - Even lengths 16" to 28"
- Load Rating: 250 lbs. per pair (18" standard)

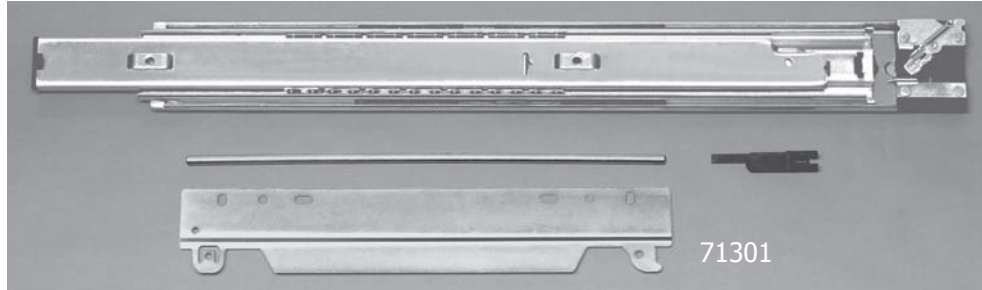

53MM 250 LB. HEAVY DUTY DRAWER SLIDES

- Applications: Lateral files, file drawers, storage drawers
- Features: Custom hole or bayonet configurations available; separable or non-separable inner channel; hardened steel ball bearings
- Slide Travel: Full extension
- Material: Work hardened cold rolled steel
- Finish: Electro-zinc plated with clear chromate; black electrocoat available
- Slide Lengths: Even lengths 10" to 28"; custom sizes available
- Load Rating: 250 lbs. per pair (18" standard)



76MM 500 LB. HEAVY DUTY SLIDES

- Applications: Lateral files, file drawers, storage drawers
- Features: Custom hole or bayonet configurations available; non-separable inner channel; hardened steel ball bearings
- Slide Travel: Full extension
- Material: Work hardened cold rolled steel
- Finish: Electro-zinc plated with clear chromate; black electrocoat available
- Slide Lengths: Even lengths 10" to 28"; custom sizes available
- Load Rating: 500 lbs. per pair (18" standard)



Disclaimer: Our drawer slides meet industry-accepted guidelines using a minimum testing of 50,000 cycles that follow the ANSI/BIFMA specifications. Each slide is rated for a dynamic load that will not fail using an 18" pair. The load rating of each drawer slide will decrease proportionally beyond the 18" length. The static load capacity of each model is at least twice the dynamic load rating even when the slide is loaded to its maximum rating. Each slide should be tested in the intended application by the customer to make sure performance is not affected.

97021 - 3.75" BRUSHED ALUMINUM HANDLE PULL

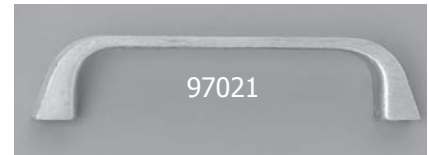
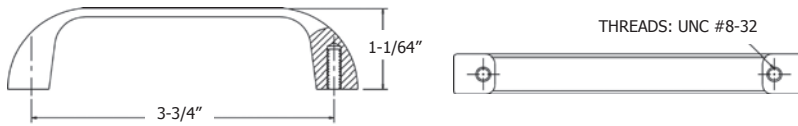

97194 - 4" BRUSHED ALUMINUM HANDLE PULL

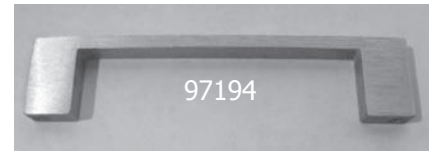
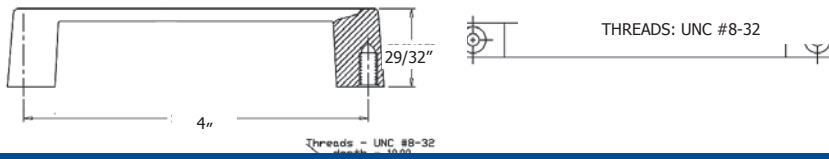

97014 - 2.75" OR 3" CHROME PLATED ZINC DIE CAST HANDLE PULL

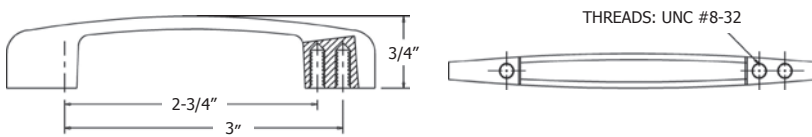

97003 - 4" CHROME PLATED ZINC DIE CAST HANDLE PULL

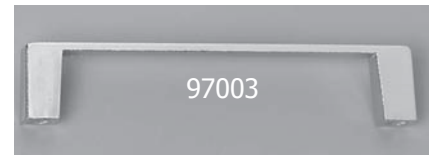
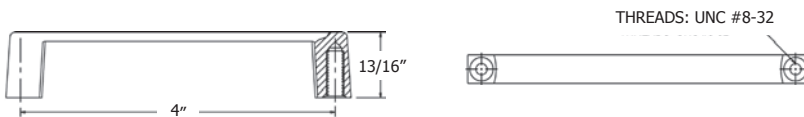

97077 - 4" SATIN CHROME PLATED ZINC DIE CAST HANDLE PULL

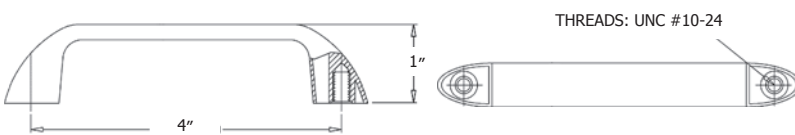

97063 - 4" SATIN CHROME OR CHROME PLATED STEEL WIRE PULL

- Two #8-32 X 3/8" Phillips head screws included

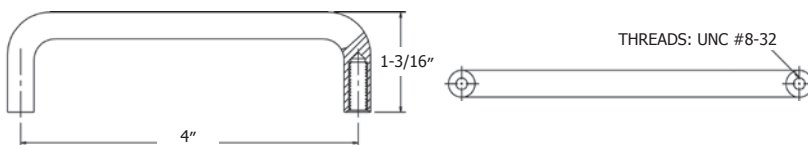

97186 - 4" STAINLESS STEEL HANDLE PULL

- Two #8-32 X 1" Phillips head screws included

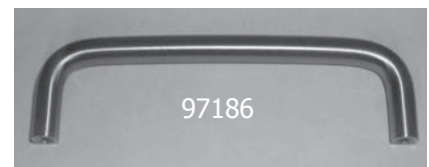
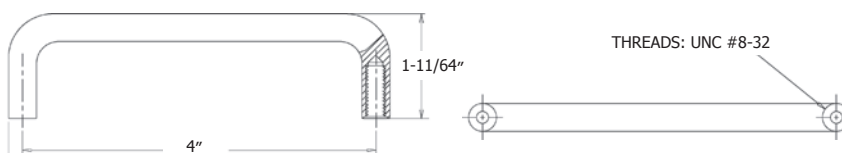

19 Custom Handles



CUSTOM DESIGNS TO YOUR SPECIFICATIONS AVAILABLE

ALUMINUM HANDLES

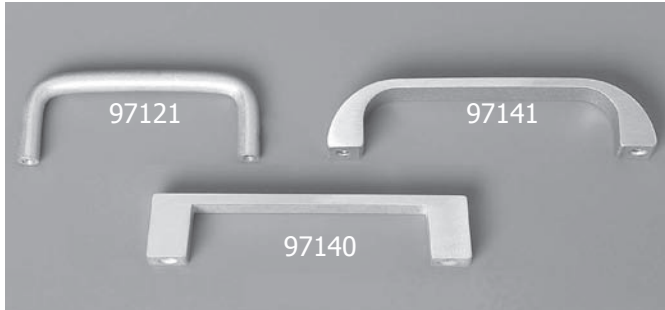

PLASTIC HANDLES



ZINC DIE CAST HANDLES



STEEL HANDLES



STEEL WIRE PULLS



LOGO HANDLES

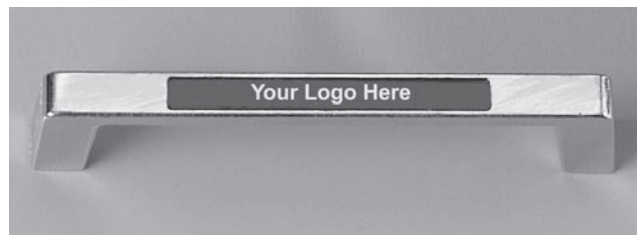

Knobs



T HANDLES, LOCKING, NON-LOCKING & DUMMY

- For cabinets, access doors, enclosures & chutes
- Available for one, two or three point locking systems
- Non-locking & dummy handles available
- Lever to your specification
- Available in 90°, 180° & 360° rotations
- 5/16" square shank
- Spindle available in various lengths; threaded & non-threaded
- Various finishes available

**L HANDLES, LOCKING, NON-LOCKING & DUMMY**

- For cabinets, access doors, enclosures & chutes
- Available for one, two or three point locking systems
- Non-locking & dummy handles available
- Lever to your specification
- Available in 90°, 180° & 360° rotations
- 5/16" square shank
- Spindle available in various lengths; threaded & non-threaded
- Various finishes available
- Supplied with J-cam

**POP OUT T HANDLES, POP OUT LOCK CYLINDERS**

- Pop out T Handles typically used in vending applications
- Zinc die cast housing with steel handles & studs
- Zinc die cast lock cylinder with spring bolt
- 7 pin tumbler mechanism on lock cylinder for security
- Available in 90°, 180° & 360° rotations
- Bright chrome or black finishes available

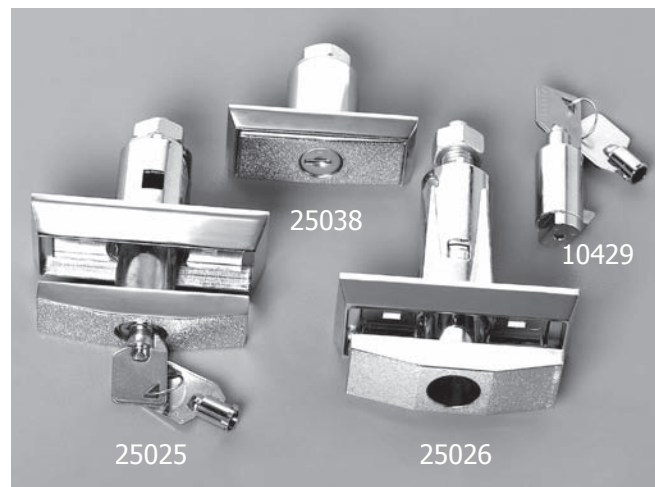

“ Wind Hardware & Engineering has been an important partner in the design of our manufactured products for many years. We take pride in our quality and are proud to have Wind Hardware as part of our finished products. We recognize Wind Hardware & Engineering for outstanding service and quality.”

Betsy K., RV industry, California

21 Access Door Hardware



14260 - FIRE DOOR LOCKS / SLAM LOCKS

- Used on fire rated access doors & hatches
- Knob, ring or key operated
- Mounting plates to required specifications
- Available with zinc or copper plating
- Available in stainless steel

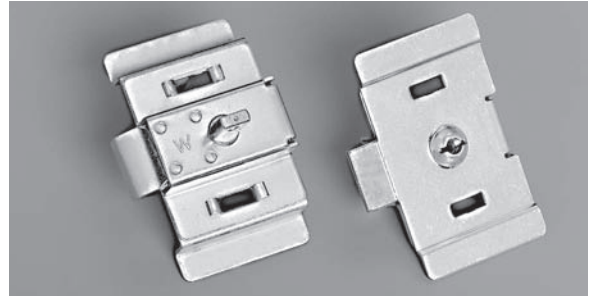

14286 - CAB LOCKS

- Used on access doors & hatches
- Left & right hand models
- Accepts 5/16" shank
- T handle available
- Mounting holes to required specifications
- Available in zinc plated steel and stainless steel 304 & 316



FRICTION SPRING CATCHES

- Used on cabinet doors
- Manufactured to required specifications
- Various finishes available

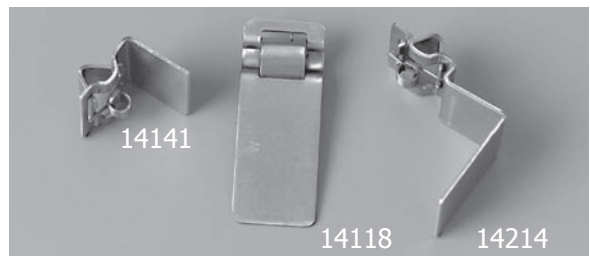

SPRING CATCHES

- Used on access doors
- Slotted head is standard
- Knurled knob, hex & torx head available
- Copper plating available for easier welding
- Available in various sizes, finishes & materials including stainless steel

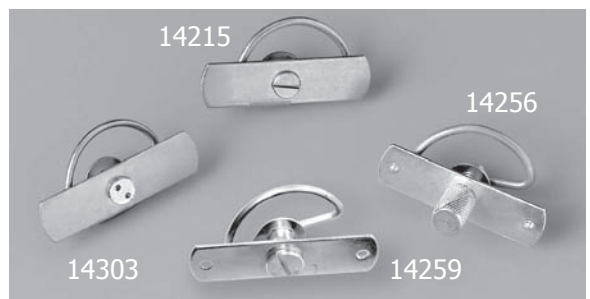

50028 - SASH LOCK & KEEPER

- Used on access doors and in the HVAC industry
- Steel with zinc plating
- Custom keeper styles available
- Available in stainless steel
- Various finishes available

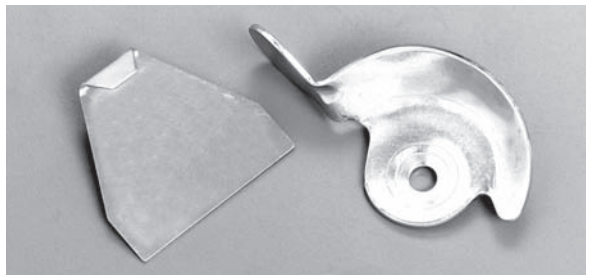

STAINLESS STEEL HINGES

- Used on access doors and storage cabinets
- Heavy duty butt hinge (shown)
- Fixed or non-fixed pins
- Custom hole patterns available
- Available in stainless steel 304 & 316

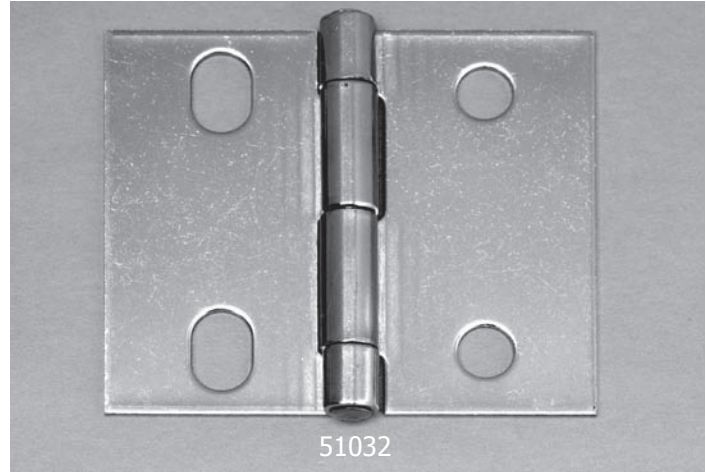

INSTITUTIONAL HINGES

- Used on educational & healthcare furniture, casework and store fixtures
- Five knuckle hinge with "Hospital Tip"
- Elongated screw holes for easy mounting alignment
- Available in steel or stainless steel
- Various finishes available



SPRING HINGES

- Used on access doors
- Fixed or non-fixed pins
- Custom spring strength per customer requirement
- Available in steel or stainless steel
- Various finishes available

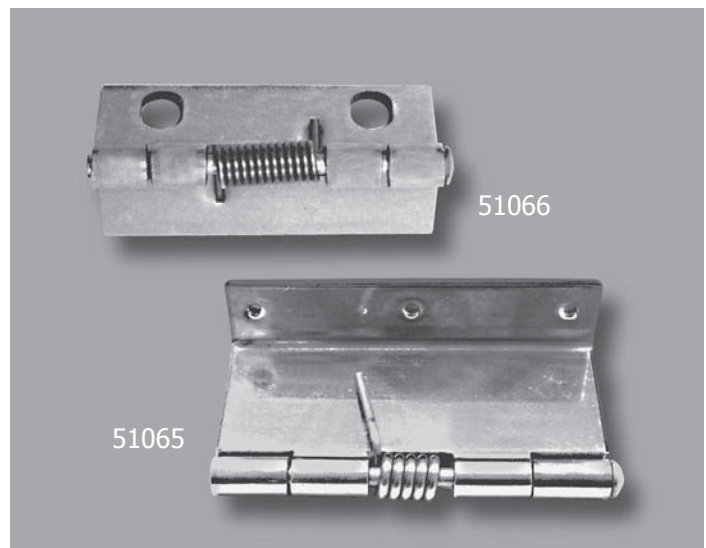

“ Proactive in reviewing customer’s future needs as well as reactive in dealing with emergency shipments. Requested product information always received promptly; excellent customer service - great to work with. ”

Alex G.
Cabinet Manufacturing ,
Ontario Canada



51059 - STOP HINGE

51082 - SPRING BOLT HINGE

51023 - HAMMERCRAFT HINGE



51031 - GLASS DOOR HINGE

51079 - SLIP OFF HINGE

51037 - INVISIBLE HINGE



51025 - BUTT HINGE

51058 - CASE HINGE

51080 - LEAF HINGE

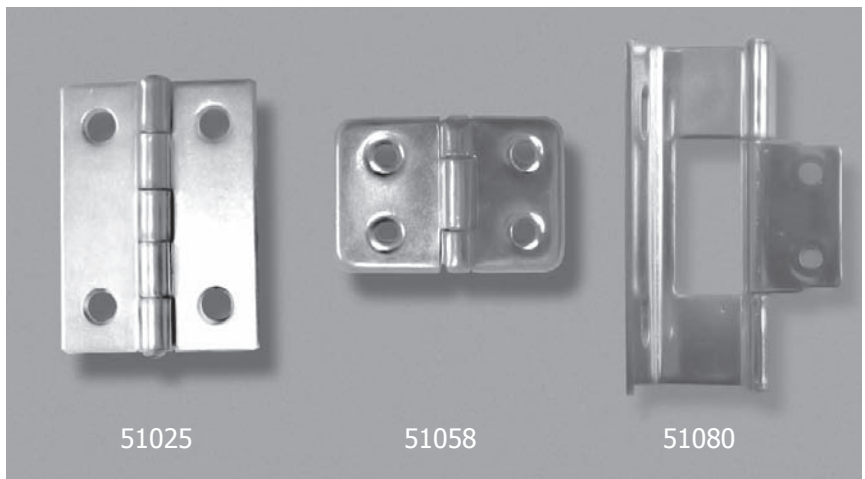

ROLLER CATCHES

- Used on cabinet doors
- Available in different sizes & finishes
- Nylon roller for smooth action
- Various roller tensions available
- Available with or without strike plate & screws

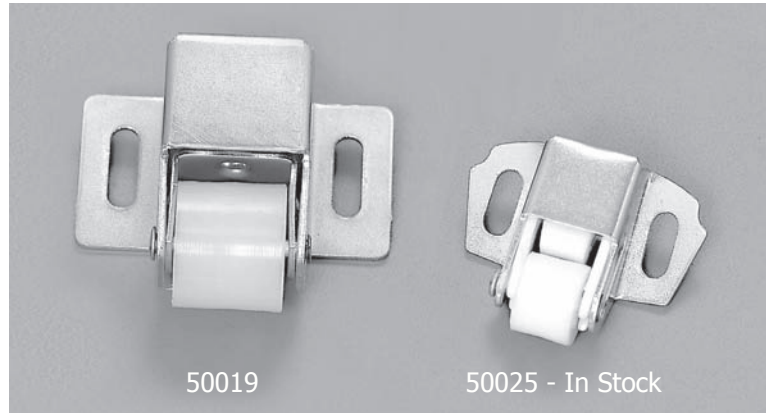

MAGNETIC CATCHES

- For use on metal & wood furniture and cabinets
- Magnetic push latches available
- Snap in feature available
- Double magnetic catches available
- Plastic housings available in black, brown & white
- Available with or without strike plates

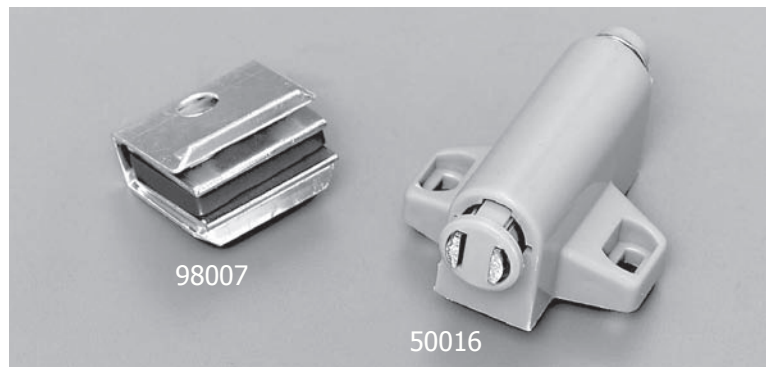

Latches

TWIST LATCHES

- Used on cabinets, utility boxes & industrial cases
- Available in various sizes, materials & finishes
- Available in non-locking or lockable versions
- Straight or offset keepers available

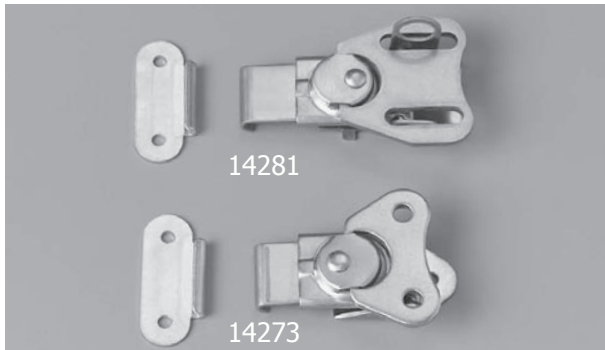

DRAW BOLT LATCHES

- Used on tool boxes & cases
- Available in various sizes, configurations & finishes
- Available with padlockable loop

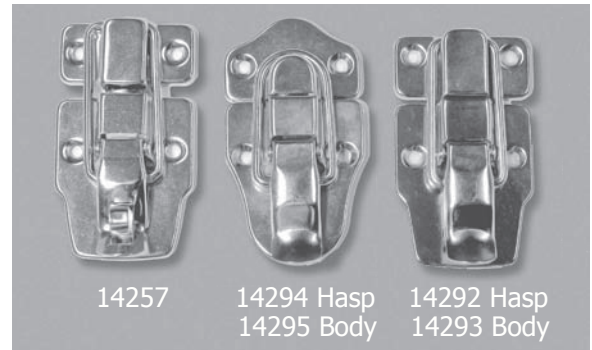



LEG LEVELERS

- For use on furniture, enclosures & cabinets
- Various thread lengths & diameter stems available
- Rigid & swivel stems available
- Various base materials & diameters available
- Various T-nuts available



Casters

FURNITURE CASTERS

- Nylon twin wheel casters
- Swivel plate, friction ring stem, threaded stem, or socket
- Hooded or unhooded
- Brake or non-brake
- Socket covers available
- 30mm to 125mm sizes available



SPECIALTY CASTERS

- Adjustable leveling foot for maximum stability
- Extra hard nylon single wheel
- Double ball bearings
- 50mm wheel diameter
- 330 lb. load capacity



LIGHT DUTY CASTERS

- Available wheel options include rigid, swivel with no brake, swivel with wheel brake & swivel with total brake
- Various tread types available
- 40 to 50 mm (1-9/16" to 2") wheel diameters depending on wheel material
- 50 to 60 lb. load capacities depending on wheel material

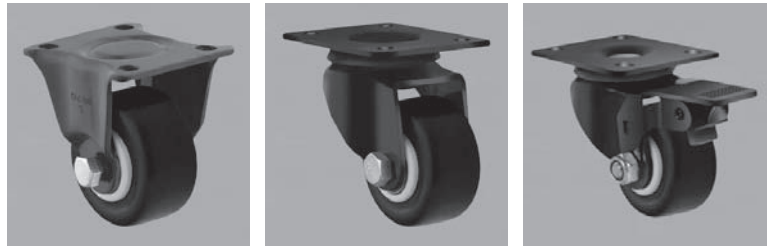
**MEDIUM DUTY CASTERS**

- Available wheel options include rigid, swivel with no brake, swivel with wheel brake & swivel with total brake
- Various tread types available
- 75 to 125 mm (3" to 5") wheel diameters depending on wheel material
- 75 to 140 lb. load capacities depending on wheel material

**HEAVY DUTY CASTERS**

- Available wheel options include rigid, swivel with no brake, swivel with wheel brake & swivel with total brake
- Various tread types available
- 100 to 200 mm (4" to 8") wheel diameters depending on wheel material
- 200 to 350 lb. load capacities depending on wheel material

**EXTRA HEAVY DUTY CASTERS**

- Available wheel options include rigid, swivel with no brake, swivel with wheel brake & swivel with total brake
- Various tread types available
- 125 to 200 mm (5" to 8") wheel diameters depending on wheel material
- 400 to 700 lb. load capacities depending on wheel material



“ Over the years we have developed a friendship which I find uncommon in business today. You have always been very helpful with the products you supply to us. Your engineering department has also been very helpful from the point of view of making sure the parts are of good material and to spec. I don't think you can ask a company to do any better than you have.

Bill W., Cabinet manufacturer , Ontario Canada

”

27 Dispenser & Cash Box Locks



DISPENSER LOCKS

- Used on washroom towel & soap dispensers and cash drawers
- Available in different sizes, materials & finishes
- Dead bolt, spring action & hook lock mechanisms available

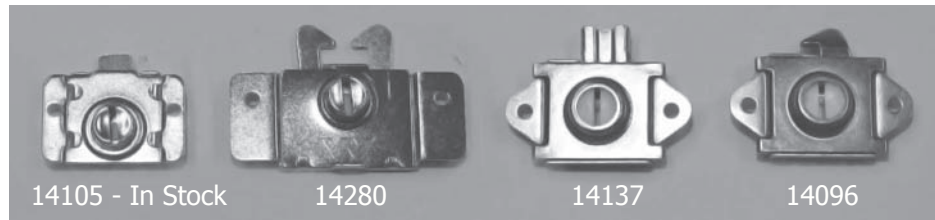

14201 - CASH BOX LOCKS

- Nickel plated
- Supplied with two keys
- Various keepers available
- 14137 keeper shown

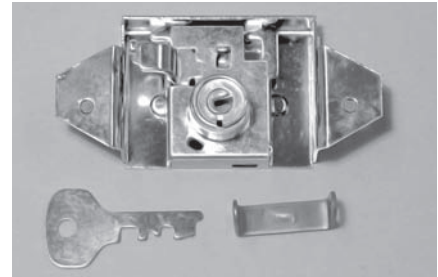

Identification Hardware, Rivets & Specialty Screws

IDENTIFICATION HARDWARE

- Badge Holders
- Strap Clips
- Luggage Straps
- Luggage Loops
- Pin Clips
- Pressure Sensitive Clips
- Magnetic Badge Holders
- I.D. Badge Clips



RIVETS & SPECIALTY SCREWS

- Pop Rivets
- Semi-tubular Rivets
- Truss and Oval Head Rivets
- Split Rivets
- Brass, Aluminum, Stainless Steel
- Plated and Non-Plated Steel



“ Wind has been a very supportive vendor for my company for over 20 years. They warehouse material for us and are very prompt when shipping releases. Wind supplies great quality products that enhance our line of goods. Claudia, Purchasing Agent, Washroom Accessories, New York ”

TRUCK & TOOLBOX LATCHES - LOCKING & NON LOCKING

- Applications: Truck Boxes - RV/Trailers - Tool Boxes - Enclosures - Cargo Compartments - Truck Body

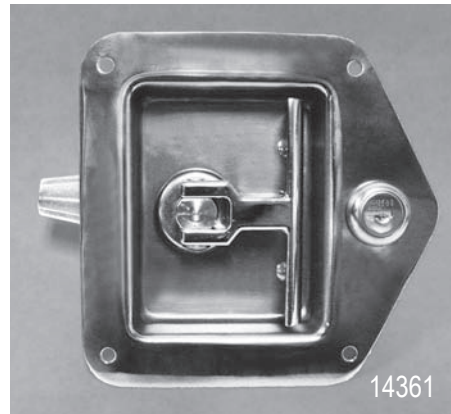
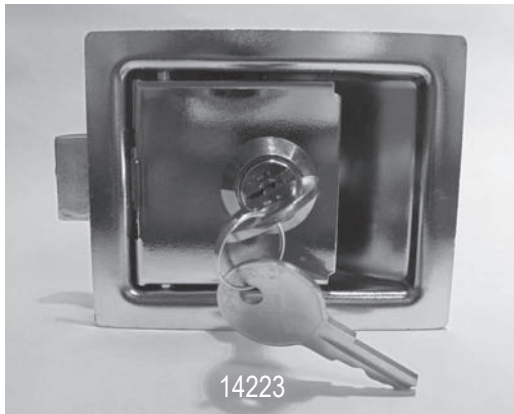
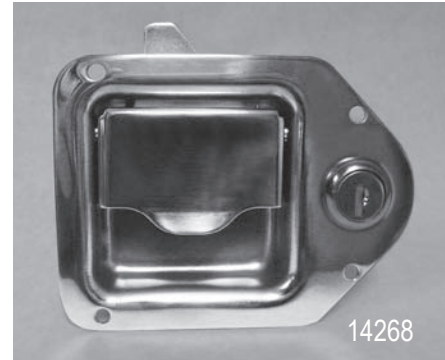
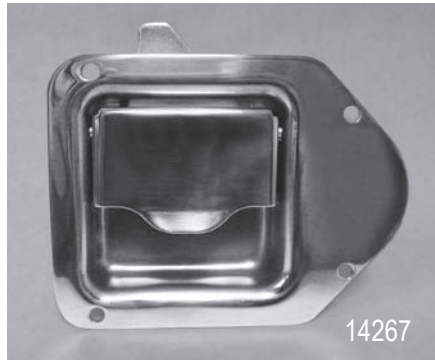

TRUCK & TOOLBOX HANDLES

- Applications: Truck Boxes - RV/Trailers - Tool Boxes - Enclosures - Cargo Compartments - Truck Body



“Winds commitment to service has always been on time, which is very helpful in the up and down flow of production in the RV business. In addition, Wind Hardware and Engineering has been a quality supplier to our company for many years. Our relationship has expanded over the years because we can count on Wind Hardware and Engineering to deliver on their commitments and to think outside the box to achieve results. As their capabilities and global presence grows, we are finding new ways to meet our objectives through the partnership that our companies have established. We know that when we test Wind Hardware and Engineering they rise to the challenge.”

Cindy, RV Manufacturing, Indiana



52021 - COMBINATION LOCK

- Nickel & brass finishes available
- Other finishes available on custom orders
- Right & left hand versions available
- Set your own combination
- **IN STOCK**

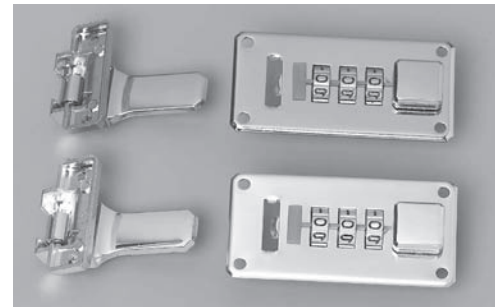
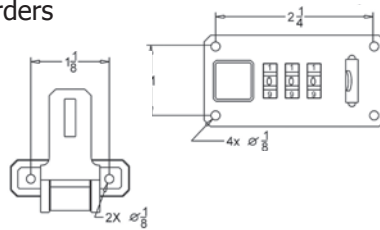

14009 & 14019 - DRAWLATCHES, FLUSH MOUNT

- Nickel & brass finishes available
- Other finishes available on custom orders
- Available in locking & non-locking versions
- Available to fit offset cases
- Available to fit valance cases on custom orders
- **IN STOCK**

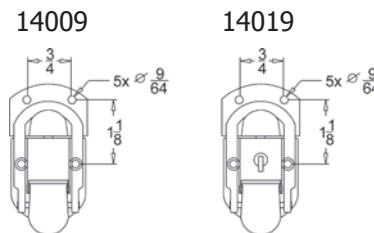

51029 - TEAR DROP HINGES

- Nickel & brass finishes available
- Other finishes available on custom orders
- Hinge opens to 90 degrees
- **IN STOCK**

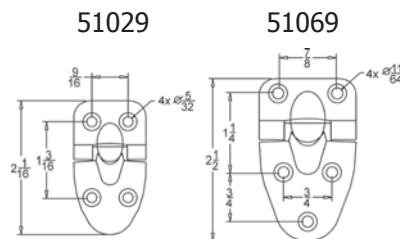

51069 - CUSTOM ORDER

Since 1949, Wind Hardware & Engineering has been supplying luggage and case hardware to the leading names in the industry. Our complete product line spans every use and application; it is far too extensive to be pictured.

- Various materials available
- Many finishes available
- Manufactured to your exact specifications
- Call us for other custom manufactured parts



“ Wind Corp. has been an integral part of our supply chain for many years, I used to deal with Werner Wind when I was a young man. That was a privilege. The company has continued to perform at the level of dedication he lived by; a TRUE legacy.
Gerry G., Case Industry, California

”



97185
PIVOT WIRE PULL



97180
GRAB BAR

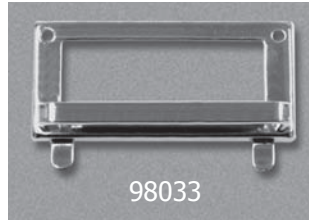

98033
CARD HOLDER HANDLE

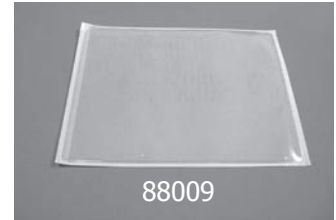

88009
PLASTIC PLANOGRAM SLEEVE



59044
SS CORNER

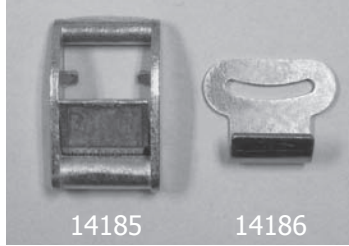

14185 14186
CAM BUCKLE & HOOK



99083
TOP ADJUSTER/RATCHET HINGE

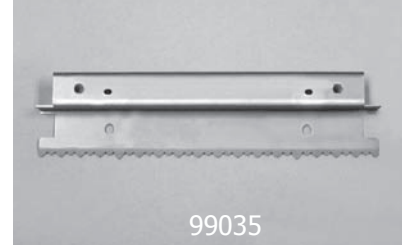

99035
PAPER TOWEL DISPENSER BLADE

MEASUREMENT CONVERSION CHART

Fractions	Decimal In.	Metric MM	Fractions	Decimal In.	Metric MM
1/64	.0156	0.39688	33/64	.5156	13.09688
1/32	.0312	0.79375	17/32	.5312	13.49375
3/64	.0468	1.19063	35/64	.5468	13.89063
1/16	.0625	1.58750	9/16	.5625	14.28750
5/64	.0781	1.98437	37/64	.5781	14.68438
3/32	.0937	2.38125	19/32	.5937	15.08125
7/64	.1093	2.77813	39/64	.6093	15.47813
1/8	.125	3.17500	5/8	.625	15.87500
9/64	.1406	3.57188	41/64	.6406	16.27188
5/32	.1562	3.97875	21/32	.6562	16.66875
11/64	.1718	4.36563	43/64	.6718	17.06563
3/16	.1875	4.76250	11/16	.6875	17.46250
13/64	.2031	5.15938	45/64	.7031	17.85938
7/32	.2187	5.55625	23/32	.7187	18.25625
15/64	.2343	5.95313	47/64	.7343	18.65313
1/4	.250	6.35000	3/4	.75	19.05000
17/64	.2656	6.74688	49/64	.7656	19.44688
9/32	.2812	7.14375	25/32	.7812	19.84375
19/64	.2968	7.54063	51/64	.7968	20.24063
5/16	.3125	7.93750	13/16	.8125	20.63750
21/64	.3281	8.33438	53/64	.8281	21.03438
11/32	.3437	8.73125	27/32	.8437	21.43125
23/64	.3593	9.12813	55/64	.8593	21.83813
3/8	.375	9.52500	7/8	.875	22.22500
25/64	.3906	9.92188	57/64	.8906	22.62188
13/32	.4062	10.31875	29/32	.9062	23.01875
27/64	.4218	10.71563	59/64	.9218	23.41563
7/16	.4375	11.11250	15/16	.9375	23.81250
29/64	.4531	11.50938	61/64	.9531	23.85219
15/32	.4687	11.90625	31/32	.9687	24.60625
31/64	.4843	12.30313	63/64	.9843	25.00313
1/2	.500	12.70000	1	1.00	25.40000



WIND

Hardware & Engineering

Email: sales@windcorp.com
Phone: 800-946-3267
Fax: 203-778-1006
Web: www.windhardware.com
30 Pecks Lane
Newtown, CT 06470 USA

Catalog Number 1-13

